



OMNI  HOTELS & RESORTS  
mont-royal | montréal



## Urban Elegance

The Hotel Omni Mont-Royal is well-known within the business community, and is located downtown on Sherbrooke Street West within the historic district of the Golden Square Mile. Concentrated on two floors, the meeting flow is ideal for event planners looking for the perfect function space to host seamless and successful events for groups of up to 500 guests. The combination of a dedicated and experienced staff and the culinary creations of Chef Laurent Miot is everything you need for the ideal event.



- 299 spacious guest rooms, including 30 suites
- 23,000 square feet of function space, including the 4,410-square-foot Salon des Saisons Ballroom, divisible into two sections
- 14 meeting rooms with wireless high-speed Internet access and in-house audio/visual services
- 400-person banquet capacity
- 480-person theater capacity
- 24-hour full-service business center
- Fully-equipped state-of-the-art fitness center
- Le Petit Opus Café showcases the best of local flavours with sumptuous meals, light snacks and sweet desserts, while Alice Bar serves a diverse menu of cocktails and savoury bites.
- Outdoor activities include hiking, biking, rafting, cross country skiing, toboggan rides and much more. Golf, tennis and squash reservations can be made through the concierge.



## FIRST FLOOR

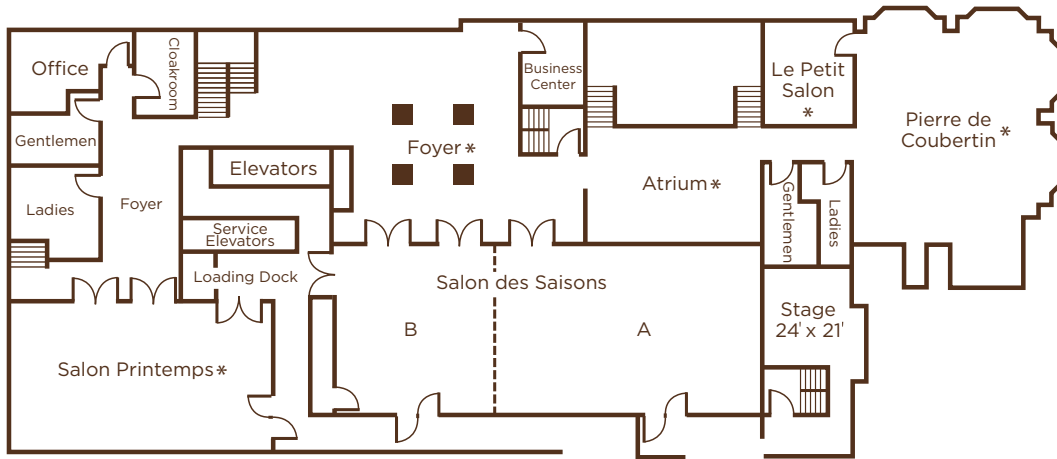

## SECOND FLOOR

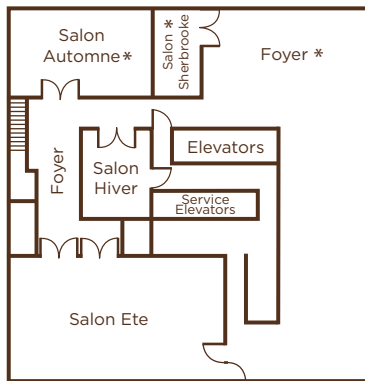

## THIRD FLOOR

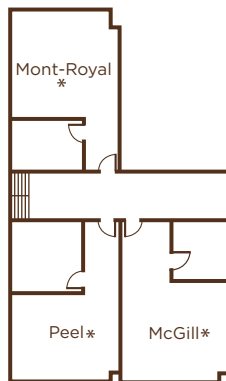

## LOWER LEVEL I

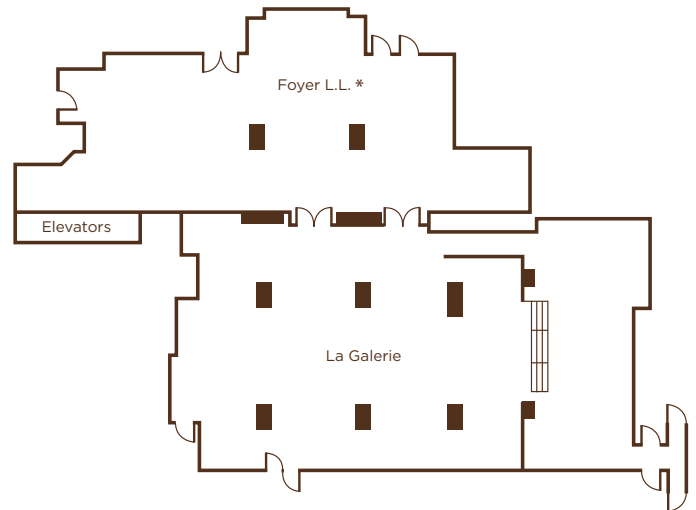

\* Natural Light

ROOM	FLOOR	CEILING HEIGHT	SQUARE FT	SQUARE M	CONFERENCE	U-SHAPE	CRESCENT ROUND	THEATER	CLASSROOM	BANQUET	EXHIBIT 8'x8'	EXHIBIT 10'x10'	HOLLOW SQUARE
Saisons A & B	1st	14	410	4,410	80	97	240	480	288	400	32	22	114
Saisons A	1st	14	242	2,610	40	63	120	300	130	200	17	10	80
Saisons B	1st	14	163	1,755	34	45	96	180	72	160	9	16	60
Pierre-de-coubertin	1st	14	276	2,700	40	44	150	180	144	250	17	11	56
Atrium	1st	14	152	1,636	50	28	48	60	36	80	6	4	30
Printemps	1st	10	185	1,972	48	54	108	180	110	180	10	6	65
Ete	2nd	10	177	1,904	48	54	102	180	110	170	10	6	65
Automne	2nd	10	69	742	24	26	30	55	28	50	2	—	30
Hiver	2nd	10	37	396	18	15	18	20	18	30	1	—	20
Sherbrooke	2nd	10	22	231	10	—	—	10	6	20	—	—	10
La Galerie	LL	9	316	3,403	48	51	144	144	72	240	14	14	54
Peel	3rd	8	24	259	10	9	—	—	—	20	—	—	12
Mont-Royal	3rd	8	27	295	10	—	—	—	—	—	—	—	—
McGill	3rd	8	28	300	10	—	—	—	—	—	—	—	—

Meeting room capacities were determined by the use of the "Arranger & Comfort Calculator," a standardized meeting room capacity measurement system used by Meeting Professionals International.

# In the heart of the *Golden Square Mile*

At the foot of Mount Royal, the Hôtel Omni Mont-Royal is steps from the chic boutiques, art galleries, bars and restaurants of the famous Crescent Street.

- 250 m to Peel Subway Station
- 400 m to McGill University
- 500 m to the Museum of Fine Arts
- 500 m to the Underground city
- 1 km to the Financial District
- 1.3 km to the Place des Arts Theatre
- 2.2 km to the Convention Center
- 2.4 km to the Notre-Dame Basilica
- 4.2 km to the Mount Royal Park
- 8.1 km to the Parc Jean-Drapeau beach
- 19 km to Pierre Elliott Trudeau Montreal International (YUL)

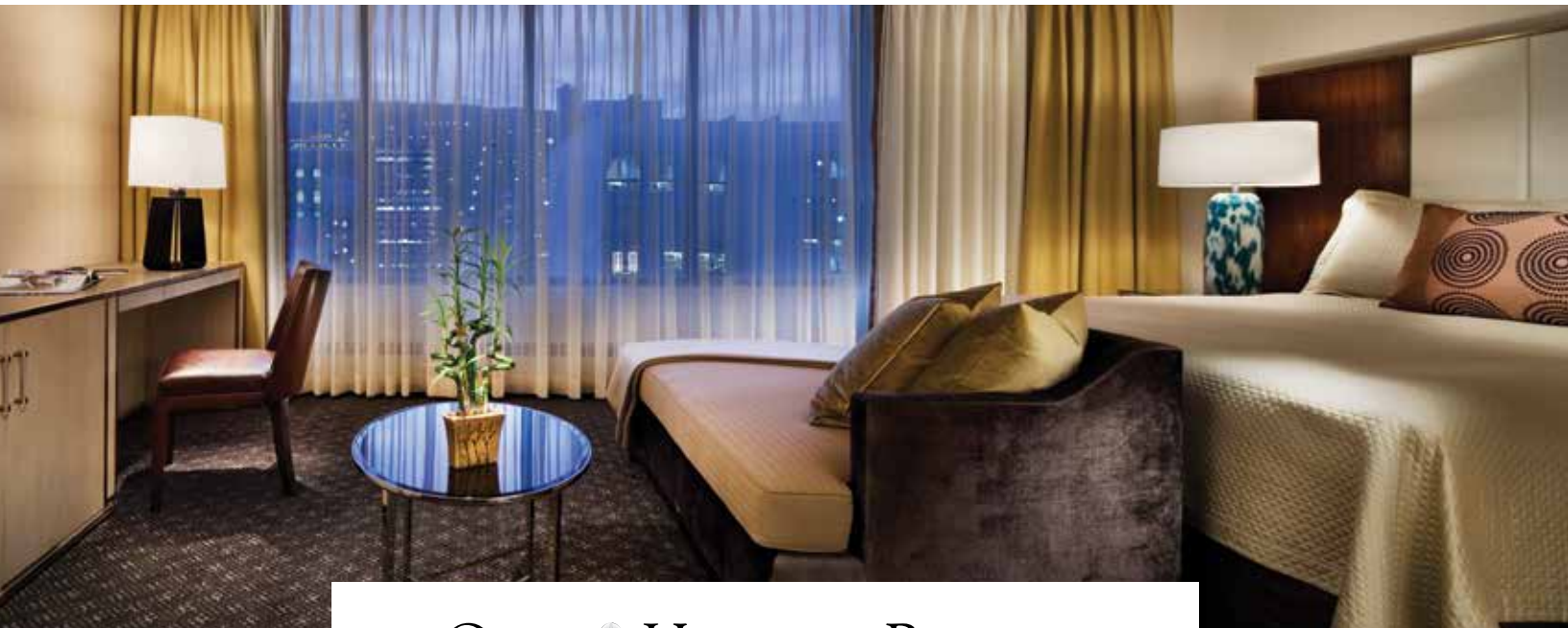
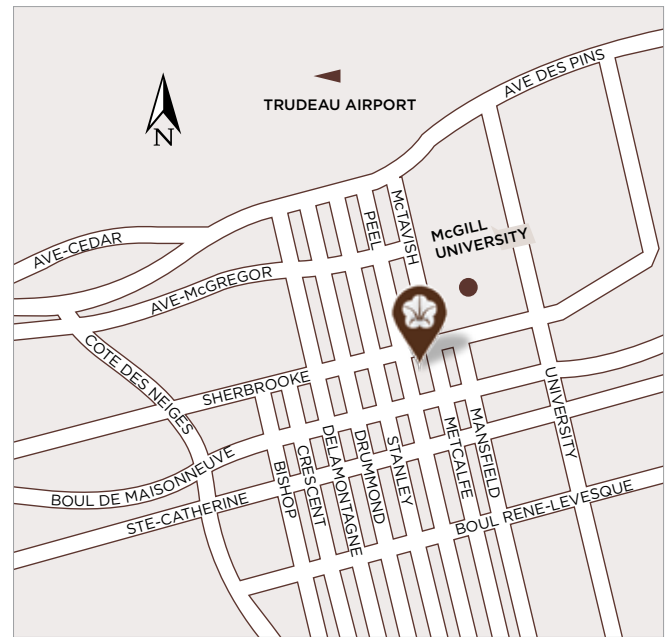

OMNI  HOTELS & RESORTS  
mont-royal | montréal

514-284-1110 • [omnihotels.com/montreal](http://omnihotels.com/montreal)

Hôtel Omni Mont-Royal • 1050 Sherbrooke Street West • Montreal, Quebec H3A 2R6